

## Penkid Installation Instructions

### Outward Opening Windows & Doors



Step 1  
Position the lock unit (C) on the fixed frame. Directly screw provided self drilling screws (E) with a crosshead screwdriver. Alternatively pilot holes can be pre-drill with a 3 mm drill bit for ease of installation ( although not essential ).



Step 2  
Position the restrictor unit (A) on the opening frame. Directly screw provided self drilling screws (E) with a crosshead screwdriver. Alternatively pilot holes can be pre-drill with a 3 mm drill bit for ease of installation ( although not essential ).



Step 3  
Clip plastic cover in to position over the restrictor unit (A). Once clipped, children can not remove plastic covers easily and reach screws.



Step 4  
Clip plastic cover (B) in to position over the lock unit (C).

### **Inward Opening Windows & Doors**



Apply the same steps as outward opening windows just with changing positions of the lock and the restrictor unit. Position the lock unit (C) on the opening frame and the restrictor unit (A) on the fixed frame.

### **Sliding Windows & Doors**



Apply the same steps as outward opening windows just with changing positions of the lock and the restrictor unit. Position the lock unit (C) on the sliding frame and the restrictor unit (A) on the fixed frame.

#### **Part List**

- A** 1 x Restrictor Units
- B** 1 x Plastic Covers
- C** 1 x Lock Units
- D** 1 x Key
- E** 4 x 4,2 mm Self Drilling Screws

#### **Tools Required**

Crosshead Screwdriver

#### **How to Operate**

To operate the Penkid, ensure the restrictor (A) is inserted in to the lock unit (C) and turn the key (D) 180 degrees. The key cannot be released in opened position. Please keep the key in a safe place.

#### **Important**

We recommend that the fixing points for this lock are fitted in a position that allows approximately 10 cm opening.

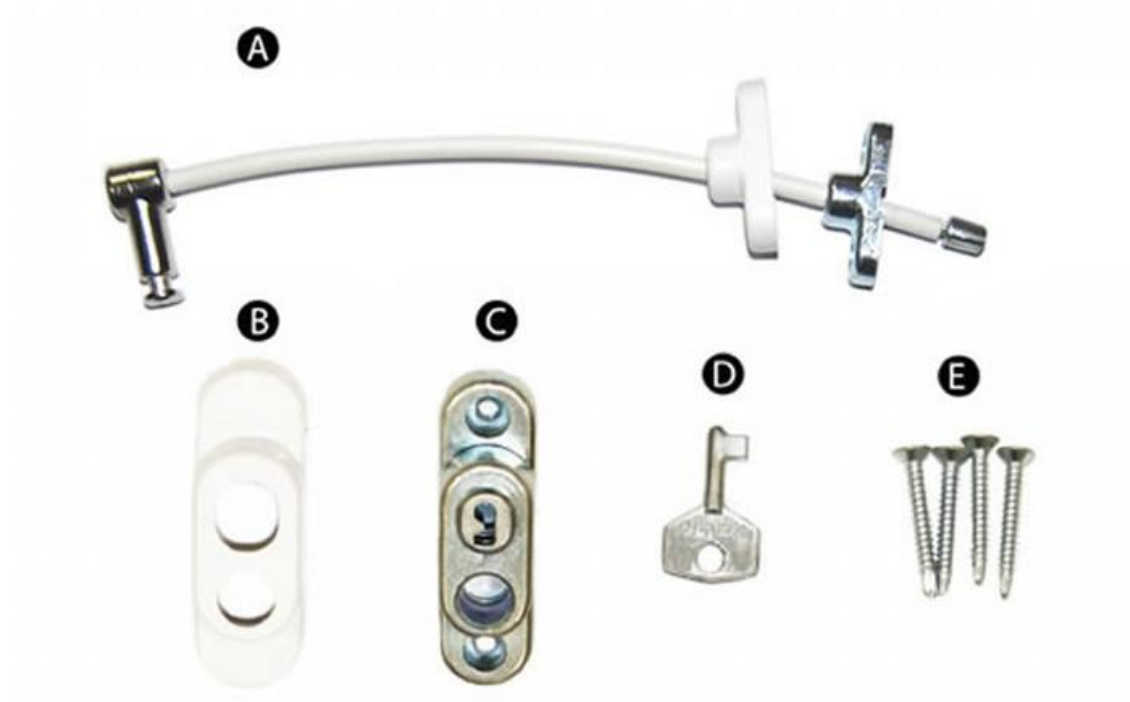

**Please Note:** The standard length of the Penkid cable is 20cm, it provides 10 - 15cm of opening depending on the installation.

The Penkid can be fitted either horizontally or vertically.

The window should be in the closed position during installation.

**Caring for your Penkid**

1. Clean your Penkid regularly with a damp cloth.
2. On a regular basis ensure that the key operates and lubricate as needed.

